

ASSESSOR MAP 1451-31-1

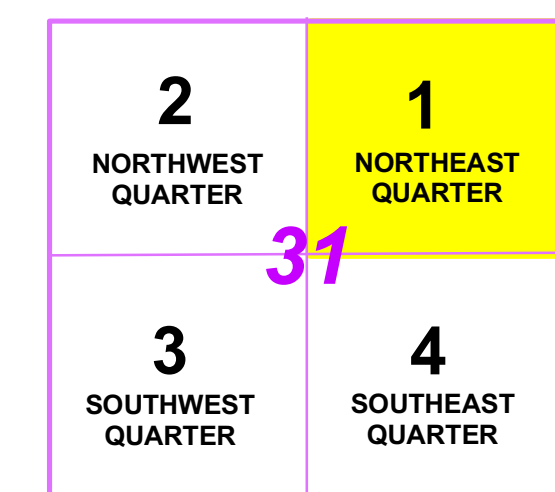
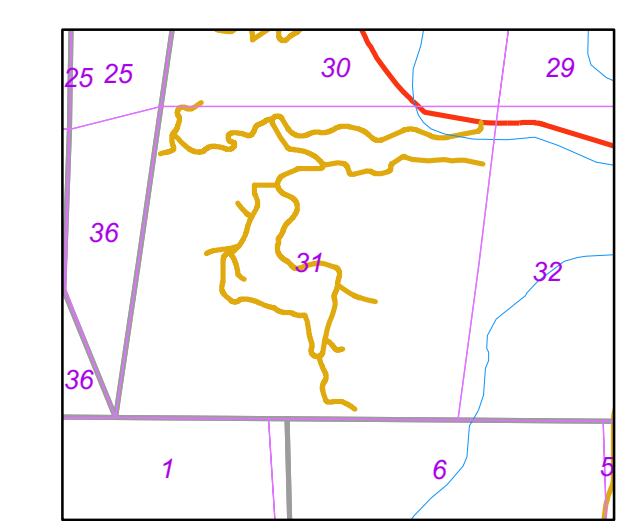

SECTION

ADJOINING
T. 1 N., R. 76 W.
1451-32-2

Township #
Section #
Quarter Section #
Block #
Property #

1451 - 311 - 05 - 001
ASSIGNED ASSESSOR PARCEL #

BLOCK # = 00 METES AND BOUNDS PARCEL
BLOCK # = 05 SUBDIVISION LOT

DESCRIPTION IN PARCEL

00-001 / 05-001 = BLOCK # - PROPERTY #
R307000 = SCHEDULE #
120 AC = ACRE
LOT #

LEGEND

- PARCELS
- TOWN LIMITS
- SECTION
- HIGHWAYS
- COUNTY ROADS
- TOWN STREETS
- PRIVATE ROADS
- OTHER ROADS/TRAILS
- RAILROAD

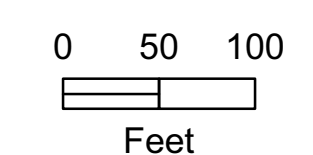

UPDATE: FEBRUARY 9, 2010

ASSESSMENT MAP
WARNING: This map is for assessment purposes only. It is NOT necessarily accurate by survey standards. DO NOT use for legal conveyances. Mapped, edited, and published by the Grand County Assessor's Office
308 Byers Ave., P.O. Box #264
Hot Sulphur Springs, CO 80451
Phone (970) 725-3347 Fax (970) 725-3303

NORTHEAST QUARTER
SECTION 31, T. 1 N., R. 76 W.

1451-31-1

1451-31-1
NORTHEAST QUARTER
SECTION 31, T. 1 N., R. 76 W.

ADJOINING
T. 2N., R. 76 W.
1451-30-4



ADJOINING
T. 1 N., R. 76 1/2 W.
1451-31-2

ADJOINING
T. 1 N., R. 76 W.
1451-31-4